

## SpitLight Compact 200 and 400 OPO

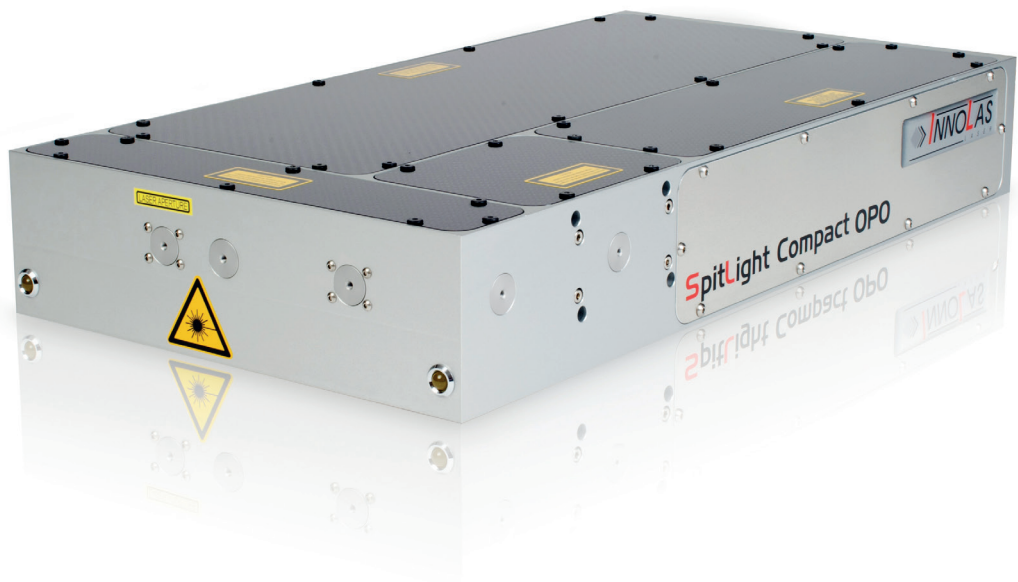

### Features

- \* Pulse to pulse wavelength tunable OPOs with wavelength ranges from 410 to 2500 nm and repetition rates up to 20 Hz
- \* High pulse energy in each spectral region resulting from diode-pumped Nd:YAG laser at 355 nm or 532 nm
- \* Stable mechanical and optical setup in a compact monolithic housing containing both laser and OPO
- \* Spitlight GUI software including wavelength calibration to control the whole device
- \* Remote client interface over TCP/IP for easy software integration
- \* Many integrated options available like energy monitor, spectrometer, automatic wavelength calibration, fiber coupling, fast attenuation or UV generation (210-410 nm)

# SpitLight Compact 200 and 400 OPO

Model	SpitLight Compact 200 OPO Broadband	SpitLight Compact 200 OPO Midband	SpitLight Compact 400 OPO Broadband	SpitLight Compact 400 OPO Midband
<b>Pump Laser Parameters</b>				
Repetition Rate	1-20 Hz (following specifications are for 10 Hz)	1-20 Hz (following specifications are for 10 Hz)	1-20 Hz (following specifications are for 10 Hz)	1-20 Hz (following specifications are for 10 Hz)
Energy @ 532nm	> 140 mJ	> 140 mJ	> 240 mJ	> 240 mJ
Energy @ 355nm	> 70 mJ	> 70 mJ	> 120 mJ	> 120 mJ
Beam Diameter	5 mm	5 mm	6.5 mm	6.5 mm
<b>OPO</b>				
Pulse Width	4-7 ns	4-7 ns	4-7 ns	4-7 ns
Tuning Range (532 nm pumped)	680-980 nm (signal) 1160-2400 nm (idler)	670-1090nm (signal) 1050-2500 nm (idler)	680-980nm (signal) 1160-2400 nm (idler)	670-1090nm (signal) 1050-2500 nm (idler)
Tuning Range (355 nm pumped)	410-690 nm (signal) 730-2500 nm (idler)	420-709 nm (signal) 709-2300 nm (idler)	410-690 nm (signal) 730-2500 nm (idler)	420-709 nm (signal) 709-2300 nm (idler)
Wavelength Shifting Time	< 50 ms (full span)	< 50ms (full span)	< 50ms (full span)	< 50ms (full span)
Line Width	10-450 cm <sup>-1</sup>	down to 5 cm <sup>-1</sup>	10-450 cm <sup>-1</sup>	down to 5 cm <sup>-1</sup>
Signal Output Energy @ 750 nm (532nm pumped)	> 40 mJ	> 30 mJ	> 60 mJ	> 50 mJ
Signal Output Energy @ 450 nm (355nm pumped)	> 18 mJ	> 16 mJ	> 30 mJ	> 27 mJ
<b>Operating Parameters</b>				
Lamp Lifetime	> 20 million shots		> 20 million shots	
Electrical Supply	208-240 VAC, 50/60 Hz, 1.5 kW		208-240 VAC, 50/60 Hz, 1.5 kW	
Cooling	Integrated*		Integrated*	
<b>Weight</b>				
Laser head	20 kg	20 kg	20 kg	20 kg
Power Supply/Chiller Unit	25 kg	25 kg	25 kg	25 kg
<b>Dimensions</b>				
Laser Head	560 x 305 x 91 mm	560 x 305 x 91 mm	586 x 305 x 91 mm	586 x 305 x 91 mm
Power Supply/Chiller Unit	480 x 220 x 480 mm	480 x 220 x 480 mm	480 x 220 x 480 mm	480 x 220 x 480 mm

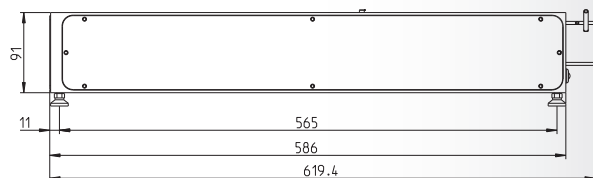
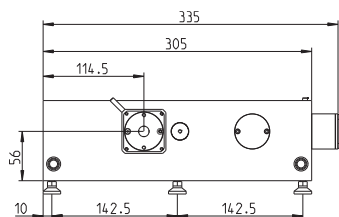

InnoLas follows a policy of continuous product improvement. All specifications are subject to change without notice.

\* Ask for details please

InnoLas Laser GmbH is DIN EN ISO 9001 certified.



**InnoLas Laser GmbH** | Justus-von-Liebig-Ring 8 | 82152 Krailling | Germany  
Phone: +49 (89) 899 360 - 1400 | Fax: +49 (89) 899 360 - 1499  
E-mail: OPO@innolas-laser.com | Homepage: www.innolas-laser.com

